

SPECIFICATIONS & DIMENSIONS

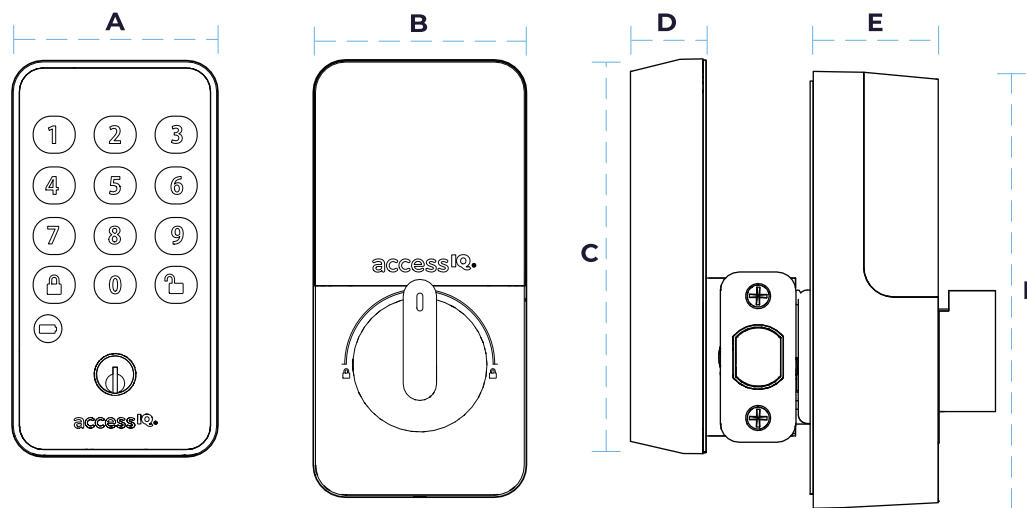

Door Prep:	Face Bore: 2-1/8 in. or 1-1/2 in., Edge Bore: 1 in.
Backset:	Adjustable for 2-3/8 in. or 2-3/4 in.
Door Thickness:	1-3/8 in. to 1-3/4 in.
Cylinder:	KW1
Faceplate:	2-1/4 in. Round corner, 2-1/4 in. Square corner
Strikes:	2-3/4 in. Round corner, 2-3/4 in. Square corner
Bolt:	1 in. Throw, steel, anti-saw pin
User Codes:	Up to 50 user codes
ANSI:	Meets ANSI Grade 2 standards
UL:	Fire Rated 20 minutes
Battery:	Rechargeable 9,600mAh Lithium-ion battery
Operating Temp:	-31°F to 151°F (-35°C to 66°C)

A	B	C	D	E	F
2.9 in.	2.8 in.	5.4 in.	1.0 in.	1.7 in.	5.8 in.



Finishes Available:



Satin Nickel
SKU: Q1001-619



Oil Rubbed Bronze
SKU: Q1001-613



Matte Black
SKU: Q1001-622

Interior height designed to accommodate a privacy latch/deadbolt



KEY FEATURES

- Connects via BLE/NFC (No Wi-Fi Required)
- Unlock with Apple Wallet/Android Smart Tap or cards/fobs
- Keypad animations and sound toggle on/off
- Both lock and unlock buttons included
- Battery status indicator (green/yellow/red LEDs)
- Keyed cylinder for backup unlocking

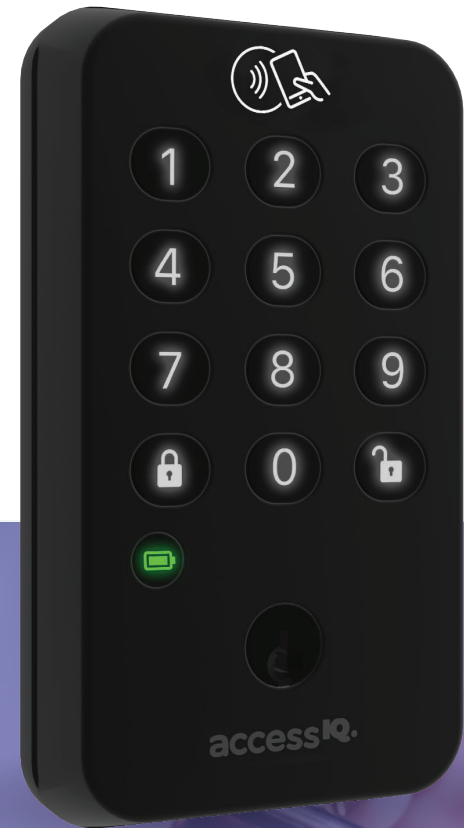

5 WAYS TO OPEN

- **Apple Wallet/
Android Smart Tap**
- **Key card**
- **Pin code**
- **Mobile app**
- **Mechanical Key**



- Motorized for remote locking and unlocking
- Rechargeable battery no recurring replacement cost or waste*
- USB C port to boost power if battery is fully drained
- Auto-hands upon installation

*Rechargeable battery that will last up to 2 years on a single charge. Extrapolated from real-world usage data. Battery usage from 100% to 4%.